



HID ignitors for series systems

SX 73 220-240V 50/60Hz

HID ignitors for series systems

Product data

• General Characteristics

| | |
|--------------------------|-----------|
| Application code | 73 |
| Rated Lamptype | SOX |
| Rated Number of Lamps | 1 piece |
| Rated Ballast-Lamp Power | 180 |
| Line Voltage | 220-240 V |
| Line Frequency | 50/60 Hz |
| Housing | SNI-85 |

• Operating Characteristics

| | |
|--------------------------------|--------------|
| Ignition type | Parallel |
| Ignition Voltage | 1.4 (max) kV |
| Response voltage | 198 V |
| Mains voltage safety (AC) | -10%/+10% |
| Mains voltage performance (AC) | -8%/+6% |
| Power losses gear | 1.0 W |

• Wiring Characteristics

| | |
|-----------------------------|---------------------------|
| Cable-Cap wires device/lamp | 5 nF |
| Connector type | Screw |
| Striplength | 6.0 mm |
| Wcs Ballast contacts | 0.50-2.50 mm ² |

• Temperature Characteristics

| | |
|----------------|------------|
| T-case maximum | 80 (max) C |
|----------------|------------|

| | |
|-----------|-----------------------|
| T-ambient | -20 (min), 75 (max) C |
| T-storage | -25 (min), 80 (max) C |

• Product Dimensions

| | |
|-----------|---------|
| Length A1 | 85.5 mm |
| Width B1 | 41.5 mm |
| Height C1 | 38.5 mm |

• Approval & Application Chars

| | |
|------------------|-----|
| CE marking | Yes |
| ENEC certificate | Yes |

• Product Data

| | |
|-----------------------------|------------------------|
| Order code | 913700625466 |
| Full product code | 913700625466 |
| Full product name | SX 73 220-240V 50/60Hz |
| Order product name | SX 73 220-240V 50/60Hz |
| Pieces per pack | 1 |
| Packing configuration | 48 |
| Packs per outerbox | 48 |
| Bar code on pack - EAN1 | 8711500920058 |
| Bar code on outerbox - EAN3 | 8711500908209 |
| Logistic code(s) - 12NC | 913700625466 |
| Net weight per piece | 0.060 kg |

PHILIPS

Dimensional drawing

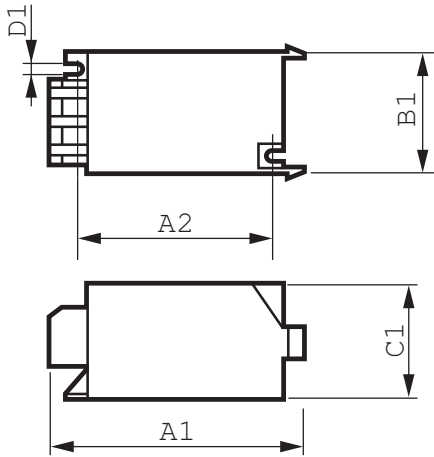

SX 73 220-240V 50/60Hz

| Product | A1 (Norm) | A2 (Norm) | B1 (Norm) | C1 (Norm) | D1 (Norm) |
|------------------------|-----------|-----------|-----------|-----------|-----------|
| SX 73 220-240V 50/60Hz | 85.5 | - | 41.5 | 38.5 | - |

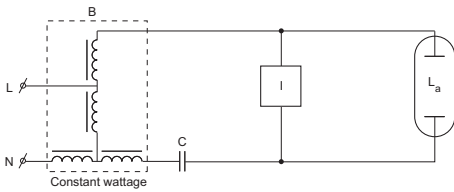

© 2015 Koninklijke Philips N.V. (Royal Philips)
All rights reserved.

Specifications are subject to change without notice. Trademarks are the property of Koninklijke Philips N.V. (Royal Philips) or their respective owners.

www.philips.com/lighting

2015, July 15
data subject to change