



# HID ignitors for series systems

SI 52 220-240V 50/60Hz

HID ignitors for series systems

## Product data

### • General Information

Application Code	52
Lamp Type	HPI
Number Of Lamps	1 piece/unit

### • Operating and Electrical

Input Voltage	220 to 240 V
Input Frequency	50-60_1 Hz
Igniton Type	Parallel
Number Of Ignition Pulses	1
Ignition Voltage (Max)	0.75 kV
Response Voltage	190 V
Mains Voltage	-8%+6%
Performance (AC)	
Mains Voltage Safety (AC)	-10%+10%
Power Losses (Nom)	1.0 W

### • Wiring

Cable Capacity	35 nF
Wires Device To Lamp (Nom)	
Wire Striplength	6.0 mm
Ballast Contact Wire Cross Section	0.70-2.50 mm <sup>2</sup>
Connector Type	Screw

### • System characteristics

Rated Ballast-Lamp Power	1000 W
--------------------------	--------

### • Temperature

T-Ambient (Max)	75 °C
T-Ambient (Min)	-20 °C
T-Storage (Max)	80 °C
T-Storage (Min)	-25 °C
T-Case Maximum (Max)	80 °C

### • Mechanical and Housing

Housing	SNI-85
---------	--------

### • Product Data

Full product code	871150091554230
Order product name	SI 52 220-240V 50/60Hz
EAN/UPC - Product	8711500915542
Order code	913619529966
Numerator - Quantity Per Pack	1
Numerator - Packs per outer box	48
Material Nr. (12NC)	913619529966
Net Weight (Piece)	0.060 kg

# PHILIPS

## Dimensional drawing

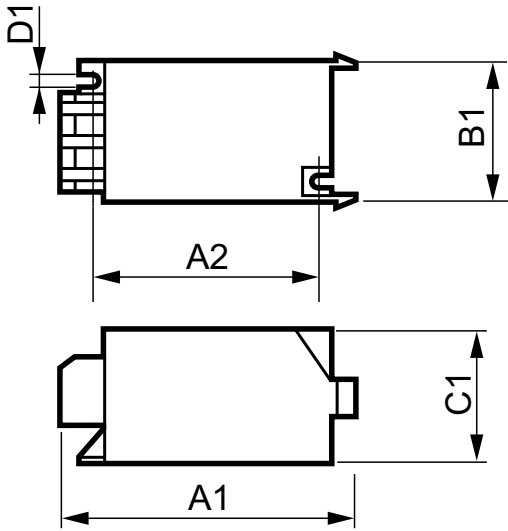

SI 52 220-240V 50/60Hz

Product	D1	C1	A1	A2	B1
SI 52 220-240V 50/60Hz	4.3 mm	38.0 mm	84.5 mm	65.0 mm	41.0 mm

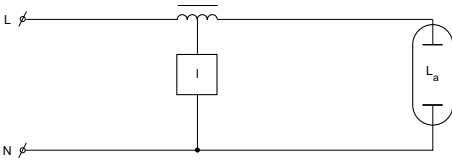

© 2015 Philips Lighting Holding B.V.  
All rights reserved.

Specifications are subject to change without notice. Trademarks are the property of Koninklijke Philips N.V. (Royal Philips) or their respective owners.

[www.philips.com/lighting](http://www.philips.com/lighting)

2015, December 24  
data subject to change