

# HF-Matchbox Red

HF-M RED 118 SH PL-C/PL-T 230-240V

HF-Matchbox Red is an affordable, reliable, compact, lightweight and high-frequency ballast for use with system wattages below 25 W in combination with TL mini, TL-D, TL5 and TL5c, PL-T/C, and PL-L/S lamps. The HF-M Red range has a robust design, meets all relevant international safety and performance standards and has an energy efficiency index (CELMA EEI ) of A2.

## Product data

### • General Information

Lamp Type	PL-C/PL-T
Number Of Lamps	1 piece/unit
Number Of Products On MCB (16A Type B) (Nom)	73
Automatic Restart	Yes

### • Operating and Electrical

Input Voltage	230 to 240 V
Input Frequency	50-60_1 Hz
Power Factor 100%	0.62
Load (Nom)	
Ignition Time (Max)	0.45 s
Mains Voltage Performance (AC)	-8%+6%
Mains Voltage Safety (AC)	-10%+10%
Power Losses (Nom)	2.0-2.1 W

### • Wiring

Connector Type Input Terminals	Insert
Color Input Terminals	Orange
Color Output Terminals	Grey
Connector Type Output Terminals	Insert
Cable Length From Device To Lamp	1.50 m
Cable Length Hot Wiring	0.30 m
Wire Striplength	8.0-9.0 mm

Input Terminal Cross Section	0.50-1.50 mm <sup>2</sup>
Output Terminal Cross Section	0.50-1.50 mm <sup>2</sup>

### • System characteristics

Rated Ballast-Lamp Power	18 W
Rated Lamp Power On PL-T	18 W
System Power On PL-T	17.3 W
Power Loss On PL-T Lamp Power On PL-T	2.1 W
System Power On PL-C	17.9 W
Rated Lamp Power On PL-C	18 W
Power Loss On PL-C Lamp Power On PL-C	2 W
	15.9 W

### • Temperature

T-Ambient (Max)	40 °C
T-Ambient (Min)	-10 °C
T-Case Maximum (Max)	75 °C

### • Mechanical and Housing

Housing	SH
---------	----

**PHILIPS**

# HF-Matchbox Red

## • Emergency Operation

Battery Voltage Lamp Ignition 194-254 V

## • Approval and Application

Approval Marks F-Marking  
CE marking  
ENEC certificate  
CB Certificate

## • Product Data

Full product code 871150092802330

Order product name HF-M RED 118 SH PL-C/PL-T  
230-240V  
EAN/UPC - Product 8711500928023  
Order code 913700423466  
Numerator - Quantity Per Pack 1  
Numerator - Packs per outer box 50  
Material Nr. (12NC) 913700423466  
Net Weight (Piece) 0.034 kg

## Dimensional drawing

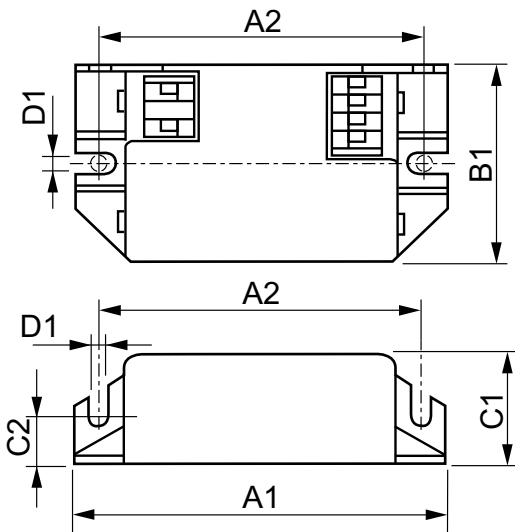

## HF-M RED 118 SH PL-C/PL-T 230-240V

Product	D1	C1	C2	A1	A2	B1
HF-M RED 118 SH PL-C/PL-T 230-240V	4.4 mm	22.0 mm	10.0 mm	80.0 mm	70.0 mm	40.0 mm

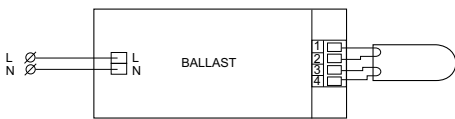

© 2015 Philips Lighting Holding B.V.  
All rights reserved.

Specifications are subject to change without notice. Trademarks are the property of Koninklijke Philips N.V. (Royal Philips) or their respective owners.

[www.philips.com/lighting](http://www.philips.com/lighting)

2015, December 24  
data subject to change