

HF-Matchbox Red

HF-M RED 124 SH TL/TL5/PL-L 230-240V

HF-Matchbox Red is an affordable, reliable, compact, lightweight and high-frequency ballast for use with system wattages below 25 W in combination with TL mini, TL-D, TL5 and TL5c, PL-T/C, and PL-L/S lamps. The HF-M Red range has a robust design, meets all relevant international safety and performance standards and has an energy efficiency index (CELMA EEI) of A2.

Product data

• General Information

Lamp Type	TL/TL5/PL-L
Number Of Lamps	1 piece/unit
Number Of Products On MCB (16A Type B) (Nom)	48
Automatic Restart	Yes

• Operating and Electrical

Input Voltage	230 to 240 V
Input Frequency	50-60_1 Hz
Power Factor 100%	0.61
Load (Nom)	
Ignition Time (Max)	0.92 s
Mains Voltage Performance (AC)	-8%+6%
Mains Voltage Safety (AC)	-10%+10%
Power Losses (Nom)	2.9 W

• Wiring

Connector Type	Insert
Input Terminals	
Color Input Terminals	Red
Color Output Terminals	Grey
Connector Type	Insert
Output Terminals	
Cable Length From Device To Lamp	1.50 m
Cable Length Hot Wiring	0.30 m
Wire Striplength	8.0-9.0 mm

Input Terminal Cross Section	0.50-1.50 mm ²
Output Terminal Cross Section	0.50-1.50 mm ²

• System characteristics

Rated Ballast-Lamp Power	24 W
Rated Lamp Power On PL-L	24 W
System Power On PL-L	22.2 W
Lamp Power On PL-L	19.3 W
Power Loss On PL-L	2.9 W
Rated Lamp Power On TL5	24 W
System Power On TL5	22.7 W
Lamp Power On TL5	19.8 W
Power Loss On TL5	2.9 W

• Temperature

T-Ambient (Max)	40 °C
T-Ambient (Min)	-10 °C
T-Case Maximum (Max)	75 °C

• Mechanical and Housing

Housing	SH
---------	----

• Emergency Operation

Battery Voltage Lamp Ignition	194-254 V
-------------------------------	-----------

PHILIPS

HF-Matchbox Red

• Approval and Application

Approval Marks F-Marking
 CE marking
 ENEC certificate
 CB Certificate

• Product Data

Full product code 871150091040030

Order product name HF-M RED 124 SH TL/TL5/PL-L
 230-240V
 EAN/UPC - Product 8711500910400
 Order code 913700420666
 Numerator - Quantity Per Pack 1
 Numerator - Packs per outer box 50
 Material Nr. (12NC) 913700420666
 Net Weight (Piece) 0.041 kg

Dimensional drawing

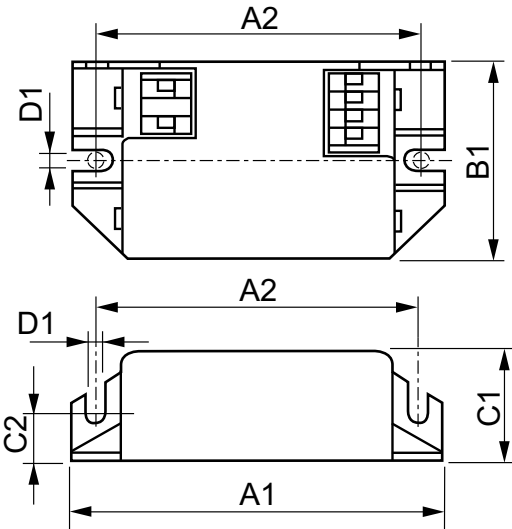

HF-M RED 124 SH TL/TL5/PL-L 230-240V

Product	D1	C1	C2	A1	A2	B1
HF-M RED 124 SH TL/TL5/PL-L 230-240V	4.4 mm	22.0 mm	10.0 mm	94.0 mm	70.0 mm	40.0 mm

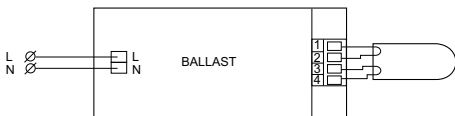

© 2015 Philips Lighting Holding B.V.
 All rights reserved.

Specifications are subject to change without notice. Trademarks are the property of Koninklijke Philips N.V. (Royal Philips) or their respective owners.

www.philips.com/lighting

2015, December 24
 data subject to change