



HF-Regulator Intelligent Touch DALI for TL5/TL-D/PL-L lamps

HF-Ri TD 4 14/24 TL5 E+ 195-240V

This intelligent high-frequency electronic dimming ballast utilizes the DALI or Touch and Dim push-button protocol for fluorescent lamps. It meets A1BAT requirements, thereby pre-empting upcoming legislation. With a special command you can retrieve the system's mains power consumption, and with another you can find out which lamp wattage is connected. Combined with controls, additional energy savings can be achieved.

Product data

• General Information

Application Code	E+
Type Version	mk4
Lamp Type	TL5
Number Of Lamps	4 piece/unit
Number Of Products On MCB (16A Type B) (Nom)	16
Automatic Restart	Yes

• Operating and Electrical

Input Voltage	195-240 V
Input Frequency	50-60_1 Hz
Operating Frequency (Max)	110 kHz
Operating Frequency (Min)	45 kHz
Ignition Method	Warm Start
Crestfactor (Max)	1.7
Power Factor 100%	0.95
Load (Nom)	
Ignition Time (Max)	1 s
Mains Voltage	-8%+6%
Performance (AC)	
Mains Voltage Safety (AC)	-10%+10%
Earth Leakage Current (Max)	0.5 mA
Inrush Current Width	0.26 ms
Standby Power Consumption (Max)	0.25 W
Ballast Factor (Nom)	1.0
Inrush Current Peak (Max)	31 A

• Wiring

Connector Type	WAGO 251 universal connector
Input Terminals	[Suitable for both automatic wiring (ALF and ADS) and manual wiring]
Cable Capacity	200 pF
Output Wires Mutual (Max)	
Connector Type	WAGO 251 universal connector
Output Terminals	[Suitable for both automatic wiring (ALF and ADS) and manual wiring]
Connector Type	WAGO 251 universal connector
Control Input Terminals	[Suitable for both automatic wiring (ALF and ADS) and manual wiring]
Wire Striplength	8.0-9.0 mm
Dual Fixture Master/Slave	Yes [Master/Slave operation possible]
Control Input Terminal Cross Section	0.50-1.00 mm ²
Input Terminal Cross Section	0.50-1.00 mm ²
Output Terminal Cross Section	0.50-1.00 mm ²
Auto Insert (ALF/ADS) Wire Cross Section	0.75 mm ²
Cable Capacity	200 pF
Output Wires To Earth (Max)	

• System characteristics

Rated Ballast-Lamp Power	14/24 W
--------------------------	---------

PHILIPS

HF-Regulator Intelligent Touch DALI for TL5/TL-D/PL-L lamps

Rated Lamp Power On TL-D	18 W	Control Input Protection	Yes (Basic insulation)
System Power On TL-D	75 W	• Mechanical and Housing	
Lamp Power On TL-D	16.6 W	Housing	L 360x39x22
Power Loss On TL-D	8.6 W	• Emergency Operation	
Rated Lamp Power On PL-L	18/24 W	Battery Voltage Lamp Ignition	198-254 V
System Power On PL-L	70.6/100.3 W	Battery Voltage Lamp Operation	176-254
Lamp Power On PL-L	15.8/22.9 W	• Approval and Application	
Power Loss On PL-L	7.4/8.7 W	Energy Efficiency Index	A1 BAT
Rated Lamp Power On TL5	14/24 W	EMI 9 kHz ... 30 MHz	EN55015
System Power On TL5	63.3/103.3 W	EMI 30 MHz ... 1000 MHz	EN 55022 Class B
Lamp Power On TL5	14.5/23.4 W	Safety Standard	IEC 61347-2-3
Power Loss On TL5	5.3/9.7 W	Performance	IEC 60929
Rated Lamp Power On TL5 ECO	13/20 W	Standard	
System Power On TL5 ECO	55/86.9 W	Quality Standard	ISO 9000:2000
Lamp Power On TL5 ECO	12.9/19.7 W	Environmental Standard	ISO 14001
Rated Lamp Power On TL-D ECO	16 W	Harmonic Current Emission Standard	IEC 61000-3-2
System Power On TL-D ECO	64.3 W	EMC Immunity Standard	IEC 61547
Power Loss On TL-D ECO	7.5 W	Vibration Standard	IEC 68-2-6 Fc
Lamp Power On TL-D ECO	14.2 W	Bumps Standard	IEC 68-2-29 Eb
Power Loss On TL5 ECO	3.4/8.1 W	Humidity Standard	EN 61347-2-3 clause 11
• Temperature		Approval Marks	CE marking ENEC certificate VDE-EMV certificate Yes
T-Ambient (Max)	50 °C	Temperature Marking	
T-Ambient (Min)	-25 °C	Emergency Standard	IEC 60598-2-22
T-Storage (Max)	80 °C	Hum And Noise Level	Inaudible
T-Storage (Min)	-40 °C	• Product Data	
T-Case Lifetime (Max)	75 °C	Full product code	871829115678900
T-Case Maximum (Max)	75 °C	Order product name	HF-Ri TD 4 14/24 TL5 E+ 195-240V
Stable Lamp Operation Temperature	> 15 °C	EAN/UPC - Product	8718291156789
T-Ignition (Max)	50 °C	Order code	913700679166
T-Ignition (Min)	-25 °C	Numerator - Quantity Per Pack	1
• Controls and Dimming		Numerator - Packs per outer box	10
Control Interface	TD	Material Nr. (12NC)	913700679166
Regulating Level Power	1%-100%	Net Weight (Piece)	0.392 kg

HF-Regulator Intelligent Touch DALI for TL5/TL-D/PL-L lamps

Dimensional drawing

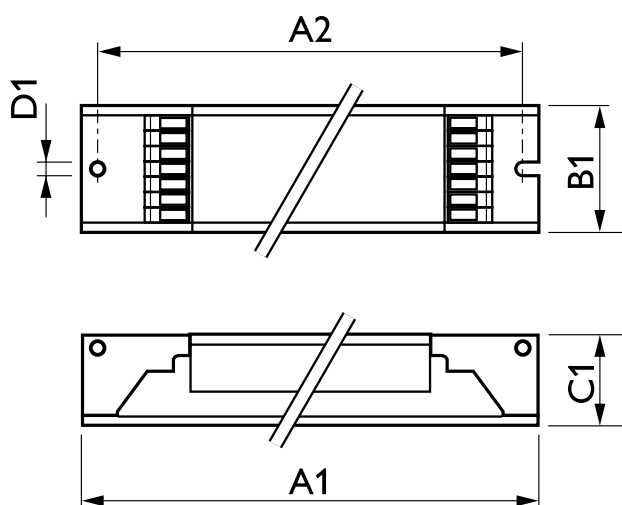

HF-Ri TD 4 14/24 TL5 E+ 195-240V 50/60Hz

Product	D1	C1	A1	A2	B1
HF-Ri TD 4 14/24 TL5 E+ 195-240V	4.2 mm	22.0 mm	360.0 mm	350.0 mm	39.0 mm

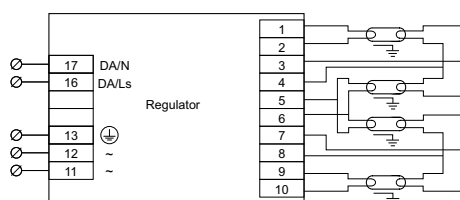

HF-Ri TD 4 lamps TL5/PL-L/TL-D



© 2016 Philips Lighting Holding B.V.
All rights reserved.

Specifications are subject to change without notice. Trademarks are the property of Koninklijke Philips N.V. (Royal Philips) or their respective owners.

www.philips.com/lighting

2016, March 24
data subject to change