



# EcoStyle

## ST440T LED27S/830 PSU MB WH

EcoStyle track mounting - LED Module, system flux 2700 lm - 830 warm white - Power supply unit - Medium beam - Safety class II - White

Retailers are looking for an affordable LED accent-lighting solution with a reasonable payback compared to conventional technologies. Now, thanks to EcoStyle, they need look no further. With a LED light source and dedicated reflector system, EcoStyle delivers powerful, good-quality accent lighting, enabling retailers to display their merchandise in the best possible light. For food and fashion retailers, EcoStyle is available with special light recipes to further enhance the store ambiance and to show the produce and goods on offer in the very best light: Fresh Food Champagne is the perfect LED solution for displaying fruit, vegetables, cheese, bread and pastries in a warm lighting ambiance; Fresh Food Meat creates the best light setting for meat enhancement in a cool natural ambiance; CrispWhite is the clear choice for fashion retailers to make colors appear rich and intense while keeping whites bright. The track-mounted EcoStyle is also available in a choice of black or white finish. And the combination of efficient LED technology and an innovative heatsink ensures that this is a reliable, lasting solution.

### Product data

General Information		Driver included	Yes
Number of light sources	1 pc	Optic type	Medium beam
Lamp family code	LED27S [ LED Module, system flux 2700 lm]	Optical cover/lens type	Acrylic bowl/cover clear
Beam angle of light source	120 °	Luminaire light beam spread	20°
Light source color	830 warm white	Connection	-
Light source replaceable	No	Cable	-
Number of gear units	1 unit	Protection class IEC	Safety class II
Driver/power unit/transformer	Power supply unit	Glow-wire test	Temperature 650 °C, duration 5 s

<b>Flammability mark</b>	For mounting on normally flammable surfaces
<b>CE mark</b>	CE mark
<b>ENEC mark</b>	ENEC mark
<b>Warranty period</b>	5 years
<b>Remarks</b>	*-Per Lighting Europe guidance paper "Evaluating performance of LED based luminaires - January 2018": statistically there is no relevant difference in lumen maintenance between B50 and for example B10. Therefore the median useful life (B50) value also represents the B10 value.
<b>Constant light output</b>	No
<b>Number of products on MCB of 16 A type B</b>	34
<b>EU RoHS compliant</b>	Yes
<b>Service tag</b>	Yes
<b>Product family code</b>	ST440T [ EcoStyle track mounting]

## Operating and Electrical

<b>Input Voltage</b>	220 to 240 V
<b>Input Frequency</b>	50 to 60 Hz
<b>Inrush current</b>	18 A
<b>Inrush time</b>	0.25 ms
<b>Power Factor (Min)</b>	0.95

## Controls and Dimming

<b>Dimmable</b>	No
-----------------	----

## Mechanical and Housing

<b>Housing Material</b>	Polycarbonate
<b>Reflector material</b>	Polycarbonate aluminum coated
<b>Optic material</b>	Polycarbonate
<b>Optical cover/lens material</b>	Polymethyl methacrylate
<b>Fixation material</b>	Polyamide
<b>Optical cover/lens finish</b>	Clear
<b>Overall length</b>	230 mm
<b>Overall width</b>	112 mm
<b>Overall height</b>	194 mm
<b>Color</b>	White

<b>Dimensions (Height x Width x Depth)</b>	194 x 112 x 230 mm (7.6 x 4.4 x 9.1 in)
--	---

## Approval and Application

<b>Ingress protection code</b>	IP20 [ Finger-protected]
<b>Mech. impact protection code</b>	IK02 [ 0.2 J standard]

## Initial Performance (IEC Compliant)

<b>Initial luminous flux (system flux)</b>	2700 lm
<b>Luminous flux tolerance</b>	+/-10%
<b>Initial LED luminaire efficacy</b>	114.8936170212766 lm/W
<b>Init. Corr. Color Temperature</b>	3000 K
<b>Init. Color Rendering Index</b>	80
<b>Initial chromaticity</b>	(0.43, 0.40) SDCM <3
<b>Initial input power</b>	23.5 W
<b>Power consumption tolerance</b>	+/-10%

## Over Time Performance (IEC Compliant)

<b>Control gear failure rate at median useful life 50000 h</b>	5 %
<b>Lumen maintenance at median useful life* 50000 h</b>	L80

## Application Conditions

<b>Ambient temperature range</b>	0 to +35 °C
<b>Performance ambient temperature Tq</b>	25 °C
<b>Suitable for random switching</b>	No

## Product Data

<b>Full product code</b>	871869625924500
<b>Order product name</b>	ST440T LED27S/830 PSU MB WH
<b>EAN/UPC - Product</b>	8718696259245
<b>Order code</b>	910500456855
<b>Numerator - Quantity Per Pack</b>	1
<b>Numerator - Packs per outer box</b>	1
<b>Material Nr. (12NC)</b>	910500456855
<b>Net Weight (Piece)</b>	1.460 kg



Dimensional drawing

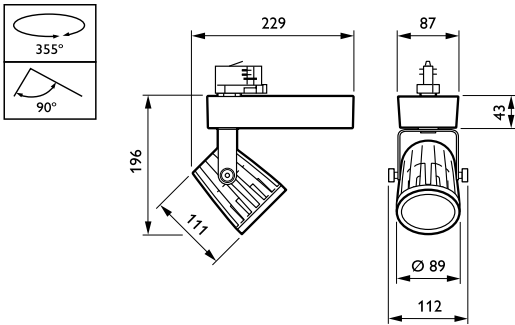

EcoStyle ST440S/ST440T

Photometric data

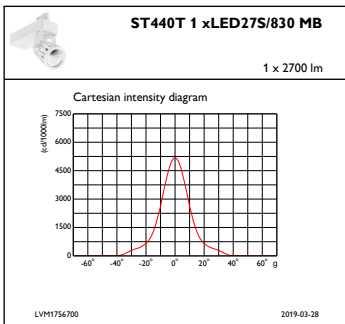

IFCC1\_ST440T1xLED27S830MB

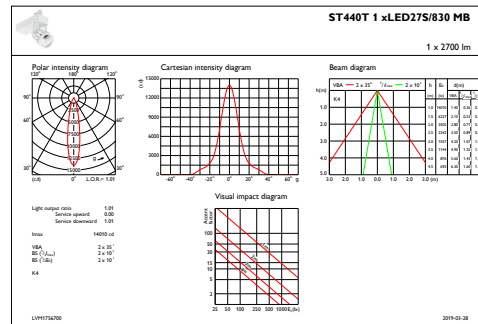

IFAS1\_ST440T1xLED27S830MB

