



GreenSpace Evo Projector

ST333T 27S/840 PSU WB WH481

GreenSpace Evo Projector, 18.8 W, 2800 lm, 4000 K, Wide beam, White

GreenSpace Evo Projector is a powerful and flexible projector for retail with a subtle and neutral design. The 3D printed housing is crafted from at least 65% recycled or bio-circular materials, while the heatsink is made from 85% recycled aluminium. Because of its circular design, the luminaire is upgradable, reusable, fully serviceable and recyclable. Combined with the high energy efficiency, this makes the GreenSpace Evo a sustainable projector choice. The PerfectAccent reflectors ensure a light effect with increased sparkle and improved shopper eye comfort. The OptiAccent (FPO) Lens technology for maximizing central light intensity. GreenSpace Evo also comes in state-of-the-art ultra-efficient variants and integrates seamlessly onto 3C- and DALI-tracks, CoreLine Trunking and Maxos fusion. Further customization of colors and textures is possible via Philips MyCreation

Warnings and Safety

- Cleaning of the optic should only be done with pressurized air. Touching the LED or reflector is forbidden. For food preparation areas and areas with high levels of dust, the use of the optional front glass is strongly advised, as it can be cleaned with a (dry) microfiber cloth
- During maintenance, the product must be switched off and cooled down
- The product must be installed out of arm's reach. Manipulating the product when hot is only possible with an insulated glove

Product data

General Information		Value ladder	Performance
Number of gear units	1 unit	Warranty period	5 years
Driver included	Yes		

GreenSpace Evo Projector

Light Technical	
Luminous Flux	2,800 lm
Correlated Color Temperature (Nom)	4000 K
Luminous Efficacy (rated) (Nom)	149 lm/W
Color rendering index (CRI)	>80
Light source color	840 neutral white
Optic type	Wide beam
Luminaire light beam spread	36°
Unified glare rating CEN	19

Operating and Electrical	
Input Voltage	220 to 240 V
Line Frequency	50 to 60 Hz
Inrush current	14.1 A
Inrush time	131 ms
Power Consumption	18.8 W
Power Factor (Fraction)	0.9
Connection	3C Track
Cable	-
Number of products on MCB of 16 A type B	60
Suitable for random switching	Not applicable
Protection class IEC	Safety class II

Controls and Dimming	
Dimmable	No
Driver/power unit/transformer	Power supply unit (On/Off)
Constant light output	No

Mechanical and Housing	
Housing Material	Polycarbonate
Reflector material	Polycarbonate aluminum coated
Optic material	Aluminum and polycarbonate
Optical cover material	-
Fixation material	-
Housing Color	White
Optical cover finish	-
Overall length	158 mm
Overall width	92 mm
Overall height	190 mm
Overall diameter	0 mm
Dimensions (Height x Width x Depth)	190 x 92 x 158 mm
Ingress protection code	IP20 [Finger-protected]
Mech. impact protection code	IK02 [0.2 J standard]
Net Weight (Piece)	0.700 kg

Emergency Operation	
Central Emergency	No

Approval and Application	
Glow-wire test	Temperature 650 °C, duration 30 s

Flammability mark	-
CE mark	Yes
ENEC mark	ENEC mark
EU RoHS compliant	Yes
Performance ambient temperature Tq	25 °C
Ambient temperature range	+10 to +25 °C

Initial Performance (IEC Compliant)	
Luminous flux tolerance	+/-10%
Initial chromaticity	(0.382,0.380)
Power consumption tolerance	+/-10%

Over Time Performance (IEC Compliant)	
Control gear failure rate at median useful life 100000 h	10 %
Lumen maintenance (EN-IEC 62722-2-1) at median useful life* 50000 h	L80

Sustainability Data	
Sustainability rating	Signify Circle
Repair class	Repair Class B, the driver and light source of this luminaire can be replaced by a service technician. Parts and documentation are available for an extended period of time.
Embedded carbon (A1-A3)	6.78 kg CO _{2e}
Product non-virgin material ratio	33.9 %
Recyclable content ratio of the finished product	40.5 %
GWP total B6 (kg CO _{2eq}) Declared Unit	Please calculate using your local energy mix value: Power Declared Unit (kW) * Service life (hrs) Declared Unit * Energy mix (kg CO _{2eq} / kWh)
GWP total B6 (kg CO _{2eq}) Functional Unit	Please calculate using your local energy mix value: Power Declared Unit (kW) * 1000 (lm) / lumen output (lm) Declared Unit * 35000 (hrs) * Energy mix (kg CO _{2 eq} / kWh)

Product Data	
Order product name	ST333T 27S/840 PSU WB WH481
Full product name	ST333T 27S/840 PSU WB WH481
Full product code	872016959086100
Order code	910505104598
Material Nr. (12NC)	910505104598
Numerator - Quantity Per Pack	1
EAN/UPC - Product/Case	8720169590861
Numerator - Packs per outer box	1
EAN/UPC - Case	8720169590861
Product family code	ST333T [GreenSpace Evo Projector Track]

GreenSpace Evo Projector

Dimensional drawing

Trafo	Flux	CCT	Optic	A (mm)
				158
PSU	205	840	HNB/HMB/HVVB/HVVB/NOVL-H/NOVL-V	171
	495	PW930	NB/MB/WB/VVVB/OVL-V	162
DIA			All	253
DIA-VLC				253
WIA				224

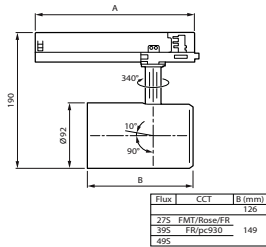

Photometric data

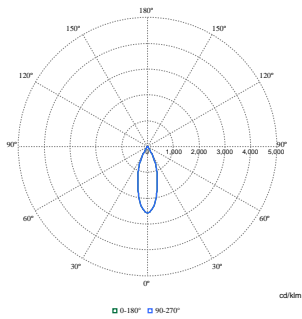

Polar Normal (separate) - ST333TI - 910505104598

